

# SHIMANO®

## MAGNUMLITE® GT-X1300 PLUS

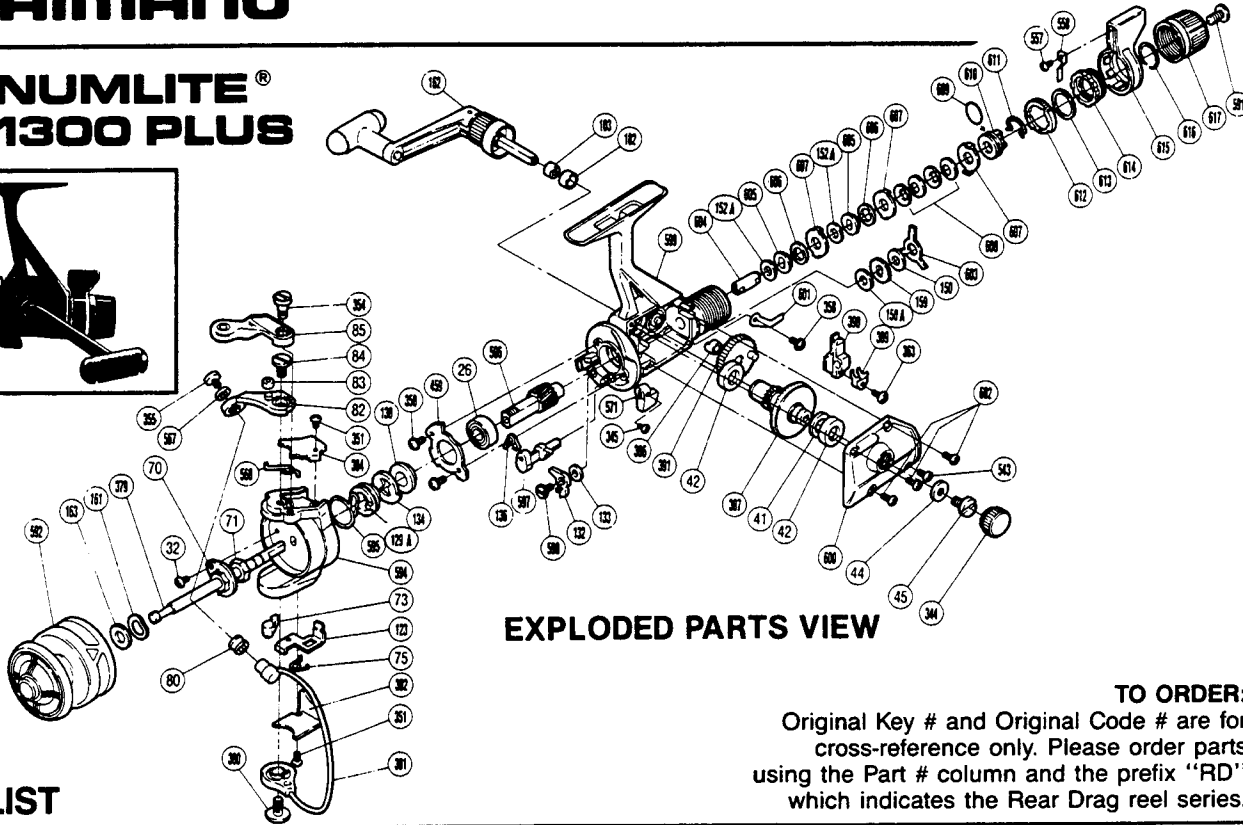
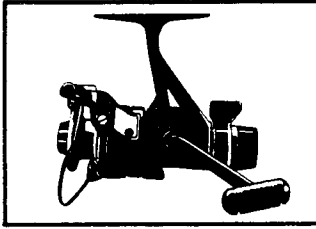

**EXPLODED PARTS VIEW**

### PARTS LIST

**TO ORDER:**  
Original Key # and Original Code # are for cross-reference only. Please order parts using the Part # column and the prefix "RD" which indicates the Rear Drag reel series.

PART #	ORIGINAL KEY #	ORIGINAL CODE #	DESCRIPTION	PART #	ORIGINAL KEY #	ORIGINAL CODE #	DESCRIPTION
592.	1.	6-0209 31213S	Spool Assembly	386.	42.	7-0537 29300S	Oscillating Gear Bushing
163.	2.	7-0217 26300S	Spool Washer	391.	43.	6-0449 27330S	Oscillating Gear Assembly
161.	3.	7-2101 09100S	Tension Spring	42.	44.	7-0617 26100S	Drive Gear Bushing
379.	4.	6-0219 27330S	Main Shaft Assembly	387.	45.	7-0408 27200S	Drive Gear
32.	5.	7-0014 30100S	Nut Lock Screw	41.	46.	7-0446 01100S	Drive Gear Washer
70.	6.	7-0360 26200S	Rotor Nut Lock Plate	600.	47.	6-0609 32300S	Side Cover
71.	7.	7-0311 01100S	Rotor Nut	44.	48.	7-0725 05500S	Handle Lock Washer
594.	8.	7-0301 29321S	Rotor	45.	49.	7-0710 05100S	Handle Lock Screw
73.	9.	7-0355 21200S	Bail Trip Slide Cam	344.	50.	7-0453 26120S	Handle Screw Cap
123.	10.	7-0336 21300S	Bail Trip Lever	601.	51.	7-0122 32300S	Drag Click
75.	11.	7-0337 21200S	Lever Spring	390.	52.	7-0410 29320S	Oscillating Slider
382.	12.	7-0338 29320S	Bail Trip Cover	389.	53.	7-0538 29300S	Oscillating Slider Retainer
351.	13.	7-0013 30111S	Cover Screw	363.	54.	7-0014 30120S	Slider Retainer Screw
381.	14.	6-0309 29320S	Bail	602.	55.	7-0011 40301S	Side Cover Screw A
380.	15.	7-0335 29220S	Bail Trip Cam Screw	543.	56.	7-0011 30710S	Side Cover Screw B
80.	16.	7-0304 01100S	Line Roller	150A.	57.	7-0139 26310S	Drag Washer "C <sub>2</sub> "
384.	17.	7-0307 29320S	Bail Spring Cover	159.	58.	7-0113 26300S	Click Gear
82.	18.	7-0303 21700S	Bail Arm	150.	59.	7-0139 26300S	Drag Washer "C <sub>1</sub> "
83.	19.	7-0356 21700S	Trigger Pin Roller	603.	60.	7-0159 32300S	Eared Washer "BF"
84.	20.	7-0306 21700S	Bail Arm Screw	604.	61.	7-0112 32300S	Drag Shaft
85.	21.	7-0357 21700S	Quick-Fire Trigger	152A.	62.	7-0140 26310S	Drag Washer "D"
354.	22.	7-0358 29220S	Trigger Screw	605.	63.	7-0115 29300S	Key Washer "A"
355.	23.	7-0013 40420S	Line Roller Screw	606.	64.	7-0146 32300S	Drag Washer "F"
567.	24.	7-0316 01110S	Lock Washer	607.	65.	7-0116 32300S	Eared Washer "B"
568.	25.	7-0310 21801S	Bail Spring	608.	66.	7-0150 32300S	Coned Disc Springs
595.	26.	7-0422 29300S	Anti-Reverse Pawl Spring	609.	67.	7-0160 32300S	"O" Ring
129A.	27.	7-0498 29320S	Anti-Reverse Spring Holder	610.	68.	7-0110 32300S	Pressure Screw
134.	28.	7-0421 21800S	Anti-Reverse Ratchet	611.	69.	7-0149 32300S	Hold Click Spring
130.	29.	7-0428 21300S	Pinion Spacer	612.	70.	7-0155 32300S	Lever Click Gear
358.	30.	7-0011 30470S	Bearing Retainer Screw	613.	71.	7-0157 32300S	Fightin' Pressure Screw Washer
459.	31.	7-0403 29300S	Bearing Retainer	614.	72.	7-0156 32300S	Fightin' Pressure Screw
26.	32.	7-0402 19300S	Ball Bearing	557.	73.	7-0010 00110S	Fightin' Drag Click Screw
586.	33.	7-0407 29320S	Pinion Gear	558.	74.	7-0154 32100S	Fightin' Drag Click
136.	34.	7-0426 21300S	Anti-Reverse Cam Spring	615.	75.	6-0441 32300S	Fightin' Drag Lever
597.	35.	7-0424 32300S	Anti-Reverse Cam	616.	76.	7-0158 32300S	Lever Hold Spring
598.	36.	7-0425 29300S	Anti-Reverse Pawl Screw	617.	77.	6-0439 30130S	Drag Programmer
132.	37.	6-0419 21800S	Anti-Reverse Pawl Assembly	591.	78.	7-0013 50410S	Drag Programmer Screw
133.	38.	7-0457 05800S	Anti-Reverse Pawl Spacer	162.	79.	6-0709 27330S	Handle Assembly
599.	39.	6-0409 32300S	Body	103.	80.	7-0743 26200S	Handle Lock Spacer
571.	40.	7-0404 32200S	Anti-Reverse Lever	102.	81.	7-0731 26200S	Handle Lock Ring
345.	41.	7-0013 00110S	Anti-Reverse Lever Screw				